

DS2000

Enclosed automatic unscrewing machine.

Operating speed up to 1,800 products/hour.

Operating principle: the vials or bottles to be unscrewed are placed on a conveyor, then aligned. They are then automatically centered, and the caps unscrewed and removed automatically.



The DS2000 is an automatic screwdriver equipped with:

- Stainless steel frame with «Sécurité» glass enclosure.
- Stainless steel control panel with touch screen.
- Motorised stainless steel conveyor, length: 3000 mm, fitted with an acetal pallet chain, width: 82.6 mm.
- Bottle-locking system using a pneumatically-guided cylinder with a cylinder head adapted to the product and position indicator for format changeover.
- Brushless motorised unscrewer.
- Torque adjustment setting on the touch screen.
- The rotation speed of the unscrewing head and the movements can be set and stored on the touch screen.
- Unscrewing device fitted with 3-finger pneumatic gripper.
- Unscrewing unit mounted on a electric cylinder with a brushless motor.
- Machine complies with CE standards.

Available options

- An automatic product infeed system (cylindrical or rectangular infeed table, transfer plate, etc.).
- Increased conveyor width (114 and 190mm).
- An additional gripper for each cap format.
- An automatic product reception system at the machine exit (cylindrical or rectangular reception table, transfer plate, etc.).

Before placing an order, we can carry out tests free of charge to ensure the feasibility of your project. Please do not hesitate to contact us!

Technical characteristics DS2000

APPROXIMATE MASS (LBS)	400 kg (depending option)
DIMENSIONS (WITH FRAME)	1005 mm in width 2100 mm in height 3003 mm of depth
POWER CONSUMPTION	1 kW
POWER SUPPLY	220 V mono
FREQUENCY	~ 50 Hz 16 A
CONTROL	by touch screen
IDEAL OPERATING TEMPERATURE	from 10°C to 30°C

Please note that this machine requires an electrical and pneumatic power supply.

Technical focus n°1

PNEUMATIC / ELECTRICAL CONNECTION

Pneumatic connection: 1 air connection on pressure gauge - Under 6 bars constant (Hose to be provided \emptyset Int/Ext = 8/10 mm).

Electrical connection: 1 Cable 220-230 volts single phase - length 6m - domestic plug

Technical Focus n°2

TOUCH SCREEN

The color touch screen allows easy adjustment of several parameters such as:

- Selection of functions to be activated
- Timer and parameter settings (pitch, unscrewing speed and torque, etc.).
- Daily product counter

Technical Focus n°3

DISPLAY DEVICE & RACK

The unscrewing device comprises a brushless electric actuator for raising and lowering the unscrewing clamp. The rotation of the clamp is also controlled by a brushless motor. All these movements can be set and stored on the touch screen (position, speed, acceleration, deceleration and torque).

Once the cap has been unscrewed, it is dropped into a drawer which is positioned under the screwing head. It then retracts to evacuate the cap, leaving room for a new cycle.

Technical focus n°4

INDEPENDENT FEEDING / RECEPTION TABLE (for cylindrical bottles only)

This table is installed at the infeed or end of the line to deposit or retrieve vials.

Independent feed table (\emptyset 700mm / \emptyset 1000mm). It is equipped with :

- HDPE railing
- A frequency inverter to modulate rotation speed
- A guide (adjustable) to bring the products to the conveyor entrance
- “No jam” sensor

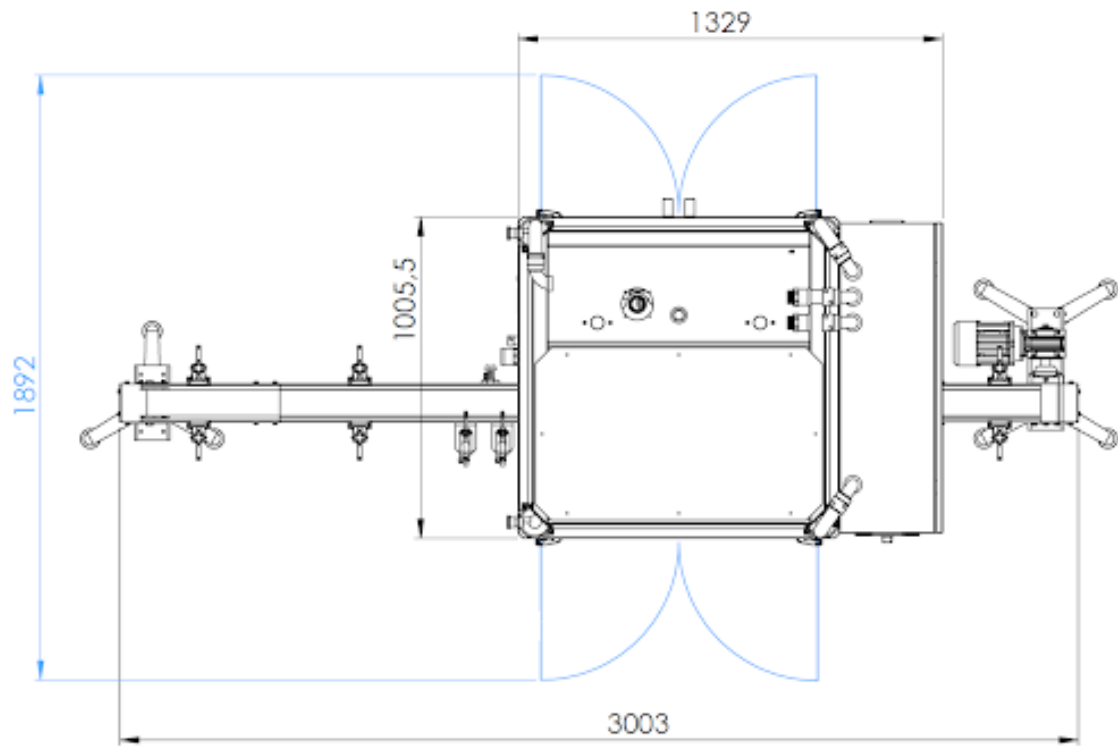

Photos, prices and descriptions are indicative and non-contractual.